

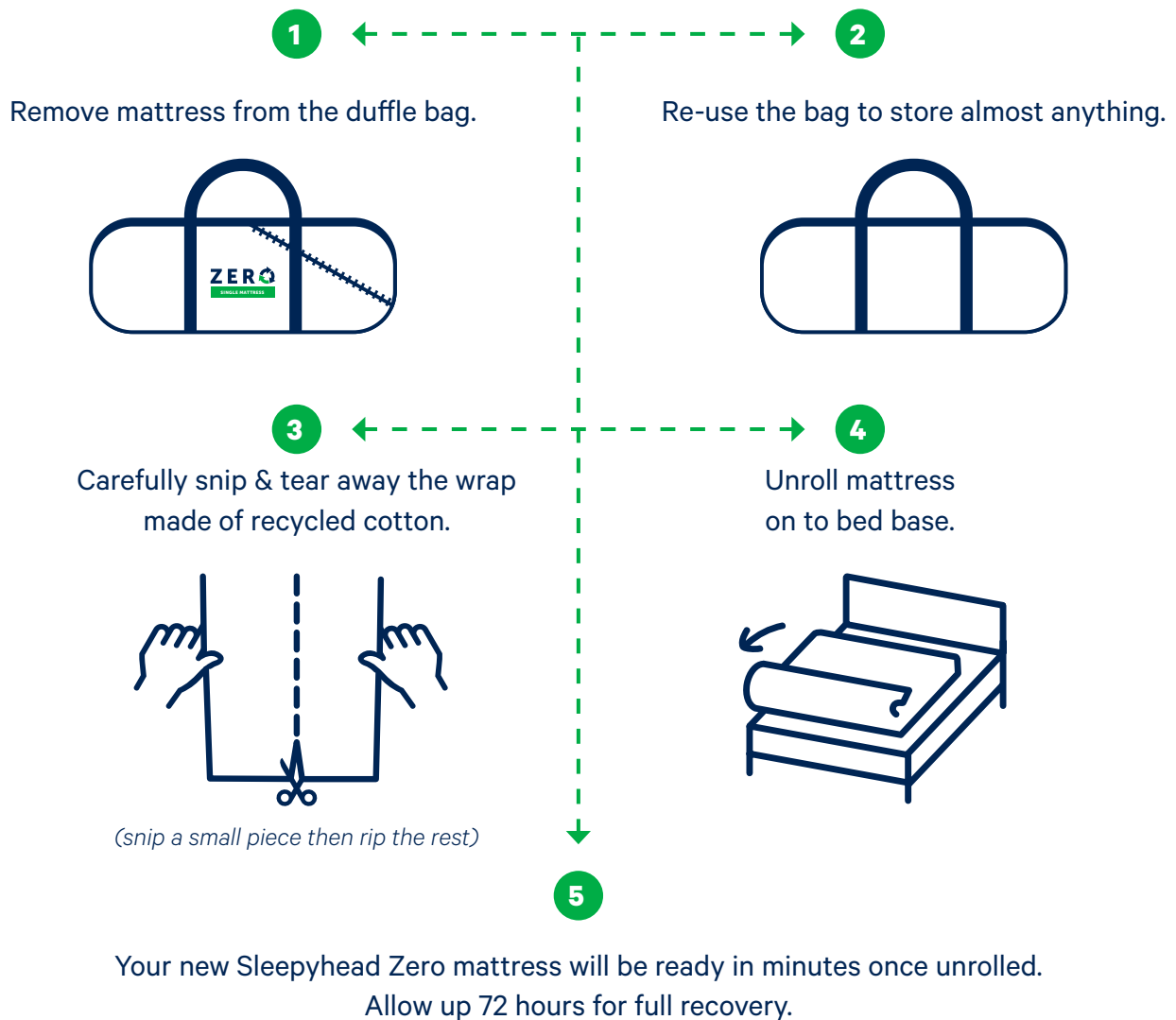

CARE INSTRUCTIONS

HOW TO SET UP SLEEPYHEAD ZERO





**ROTATE YOUR
MATTRESS EVERY
2 WEEKS
FOR THE FIRST
4 MONTHS**

**THEN ROTATE
ONCE EVERY
3 MONTHS**

CARING FOR YOUR MATTRESS

- Use a waterproof mattress protector.
- Do not remove mattress cover for cleaning.
 - Protect from direct sunlight.
 - Do not wash or bleach.
 - Do not dry clean.
 - If wet, dry in shade away from direct heat.
 - Allow to dry thoroughly before re-use.
- Any change of colour will not affect product performance.

SPOT CLEANING YOUR MATTRESS

- Treat spills & stains as soon as possible.
- Gently scrape any soil, or mop up any liquid from the fabric surface with a cloth.
 - Do not saturate the fabric or mattress inner with water or cleaning liquids.
 - Do not use dishwashing or laundry detergents to wash this mattress.
 - For oil or fatty stains, dampen a cloth with white spirit and gently wipe.
Test on inconspicuous area first.

RECYCLING YOUR ZERO MATTRESS

- We recommend you register your mattress at www.sleepyhead.co.nz so we have information about you & your new bed for the future.
 - Zero has a five year warranty.
- To recycle Zero, return it to the stockist where you purchased your bed or go to sleepyhead.co.nz/beds/zero for more information.

**REGISTER
YOUR ZERO
MATTRESS**

www.sleepyhead.co.nz

**THANKS
FOR BUYING
ZERO**

